

DIN  
TYPE

# DIN TYPE OIL-FREE EJECTOR GUIDE BUSHINGS

# CENTERING SLEEVE

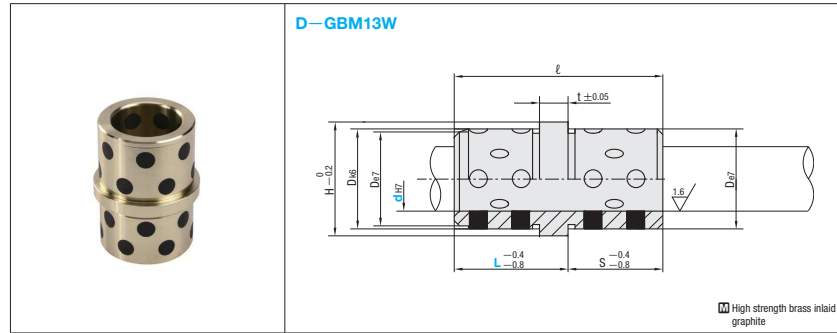

l	S	t	D	H	Part No. Type	d	L		
26	9	6	20	25	D-GBM13W	14	17		
			20			15	17		
			26			18	22		
39	17		26	31		20	22		
			30			22	27		
			30			24	27		
49	22	6	42	35	D-GBM13W	30	36		
			42			32	36		
			42			30	36		
63	27		6	42		47	D-GBM13W	32	36
				42				30	36
				42				32	36

dh7	De7	Dk6
14	+0.018 0	20
15		20
18		26
20	-0.040 -0.061	26
22		26
24		30
30	+0.021 0	30
30		30
30		42
32	+0.025 0	42
32		42
	-0.050 -0.075	42
		42
	-0.060 -0.090	54
		54
		+0.018 +0.002
		+0.015 +0.002
		+0.021 +0.002

Order **D-GBM13W** - **14** - **17**

Days to Ship **20** Days

Price **Order / Quote:**  
WOS: <https://in.misumi-ec.com/>  
TEL:+91-124-468-8800 E-mail:cs@misumi.co.in

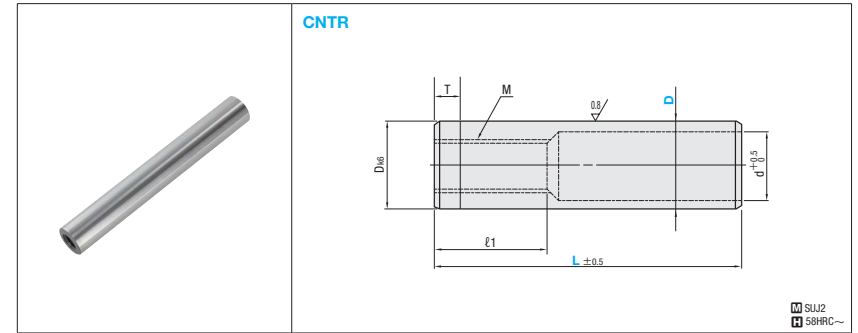

T	l1	M	d	Part No. Type	D	L
2.5	8.8	M8	11	CNTR	14	20 30 40 50 60 70 80 100
					20	30 40 50 60 80 100 120 140 160
					26	30 40 50 60 80 100 120 140 160 180
					30	40 50 60 80 100 120 140 160 180 200 220 240
					42	40 60 80 100 120 140 160 180 200 220 240 260 280 300
4	22.9	M12	43	CNTR	54	60 80 120 160 180 200 220 240 260 280 300 320
					54	80 120 160 180 200 220 240 260 280 300 320
					66	80 120 160 180 200 220 240 260 280 300 320

■ Tolerance for D and DK

D	D k6
14	-0.006 -0.017
20	-0.007 -0.020
26	-0.009 -0.025
30	-0.030 -0.049
42	+0.012 +0.001
54	+0.015 +0.002
66	+0.018 +0.002

Order **CNTR30** - **160**

Days to Ship **15** Days

Price **Order / Quote:**  
WOS: <https://in.misumi-ec.com/>  
TEL:+91-124-468-8800 E-mail:cs@misumi.co.in

