

THERMOCOUPLES

—SHEATHED THERMOCOUPLES • HEAT PROOF TYPE/COUPLING NIPPLE FOR THERMOCOUPLE—

THERMOCOUPLES

—SCREW TYPE—

Ⓜ Non JIS material definition is listed on P.1351 - 1352

Sheathed Thermocouples

RoHS

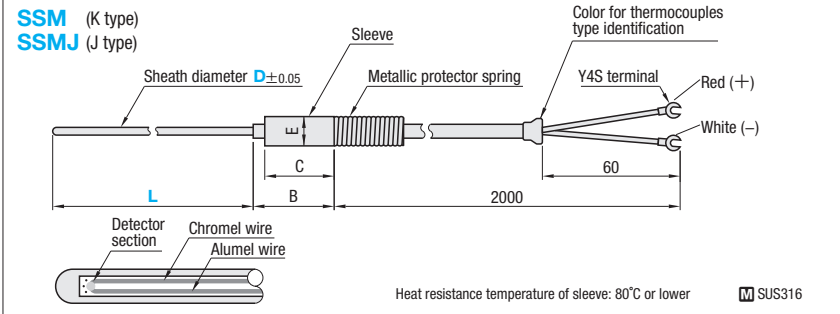

Thermocouples type (Color)	Strand resistance Ω/m	B	C	E	Max. usable temperature	Part Number		L	U/Price 1~9					
						Type	D		L50	L100	L150	L200	L250	L300
K type (Blue)	52.0	35	30	6.0	500°C	SSM	1	50~300	Quotation					
	20.0				1.6									
	9.8				2.3									
	5.0				3.2									
	2.25				4.8									
J type (Yellow)	33.6	35	30	6.0	450°C	SSMJ	1	50~150	Quotation					
	12.8				1.6									
	6.3				2.3									
	3.2				3.2									
	1.4				4.8									

Sheathed Thermocouples

RoHS

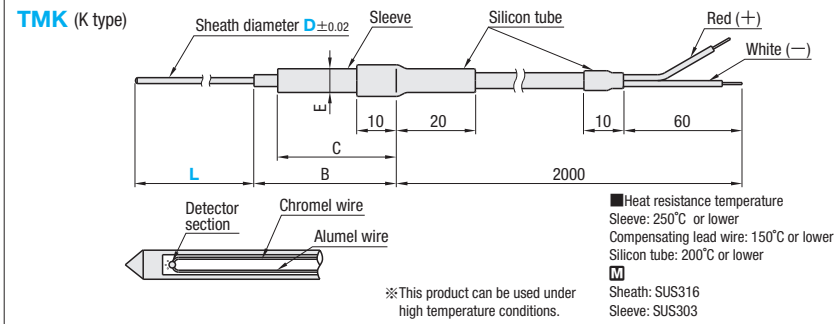

Thermocouples type	Max. usable temperature	B	C	E	Part Number		L	U/Price 1~9					
					Type	D		L50	L100	L150	L200	L250	L300
K type	650°C	36	30	5.0	TMK	1.6	50~300	Quotation					
	700°C					2.3							
	750°C					3.2							
	800°C					4.8							

CSF

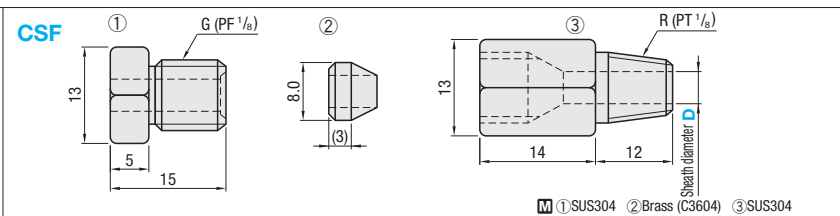

Part Number Type	D	U/Price 1~9
CSF	1	Quotation
	1.6	
	2.3	
	4.8	

EX Example Tightening the plug ① causes the component ② to tighten the thermocouple's sheath and firmly fasten it.

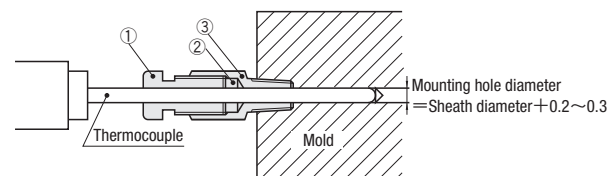

Part Number	L
TMK1.6	100
SSM1	50
CSF 1	

Order Days to Ship Quotation Price Quotation

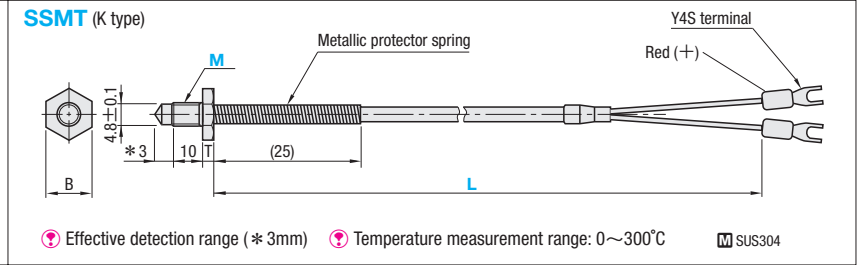

Ⓜ Effective detection range (*3mm) Ⓜ Temperature measurement range: 0~300°C Ⓜ SUS304

B	T	Part Number		L	U/Price 1~9		
		Type	M		L1000	L2000	L4000
10	4	SSMT	6	1000	Quotation		
13	5.3		8	2000	Quotation		
				4000	Quotation		

Order Part Number SSMT6 - L 1000
Days to Ship Quotation
Price Quotation

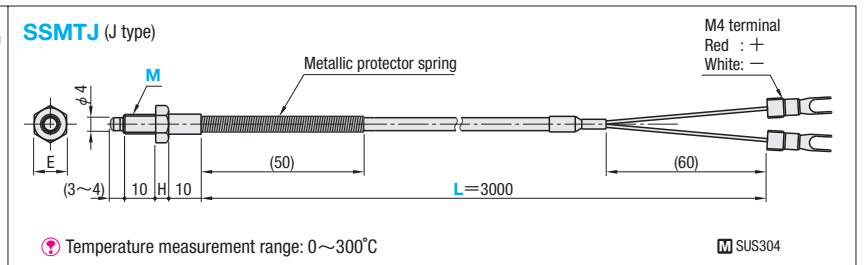
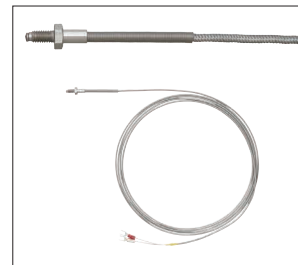

Ⓜ Temperature measurement range: 0~300°C Ⓜ SUS304

Max. usable temperature (°C)	Tip Point Material	E	H	Part Number		L	U/Price	
				Type	M		1~9	10~19
300	SUS304	10	4	SSMTJ (J type)	6	3000	Quotation	

Ⓜ To be quoted on price & lead time above Max. Q'ty.

Order Part Number SSMTJ6 - L 3000

EX Example

Days to Ship Quotation

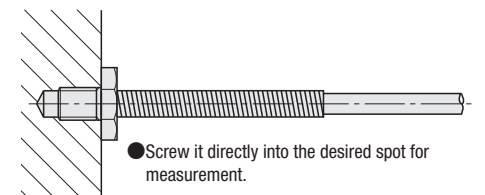

Guide for thermocouples type

Thermocouples type	Color	+ wire	- wire	Usable temperature	Max. usable temperature*	Application
K type	Blue	Chromel	Alumel	-200°C~1000°C	1200°C	Most commonly used type for industrial applications. Exhibits a linear Alumel relationship between temperature and thermoelectromotive force.
J type	Yellow	Steel	Constantan	0°C~600°C	750°C	Has high thermoelectromotive characteristics. Used in the medium temperature zone for industrial applications.

* The maximum temperature used differs according to the strand diameter, so use it only as a rough guide.