

TAPERED PIN SETS

—PIN • BUSHING PL SIDE FIXING TYPE—

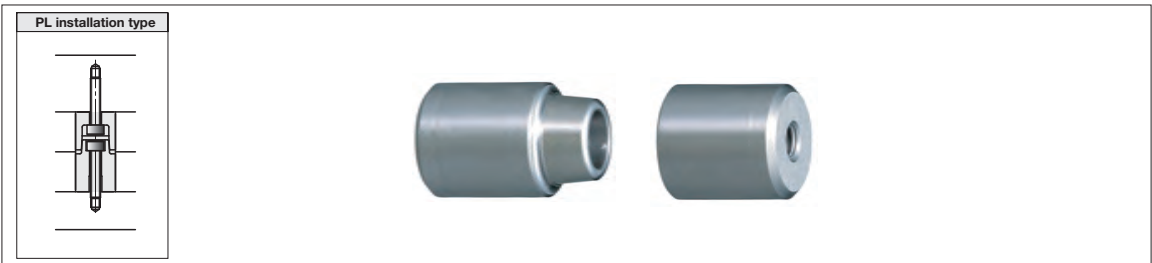

Group	Part No.	D Tolerance	Components concentricity of tapered section to the diameter of pin and bushing	M	H
	Set				
Standard	C-TPVX	D_{k6}	0.015 or less	SUJ2	58~62HRC

② Bushing

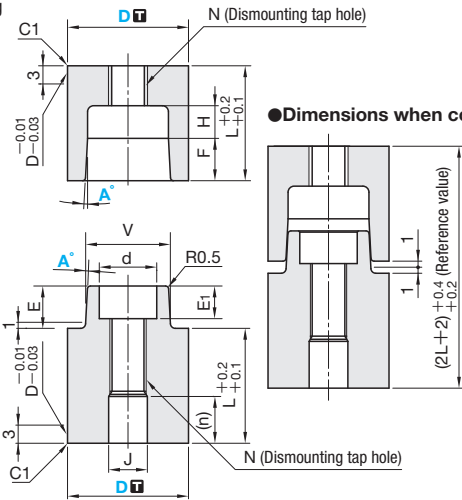

●About N dimension (Dismounting tap hole)

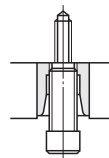

As shown in the left figure, the bushing can be easily removed by screwing a bolt into its tap and extracting it.

●Dimensions when combined

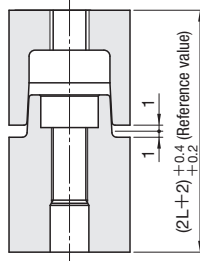

① Pin

D	L	V	E	F	H	① Pin		Bolt for mounting Pin - Bushing	N	(n) Escape hole on pin bottom	J Escape hole diameter on pin bottom
						d	E ₁				
13	14	10	6	5	3.3	6.5	3.3	M 3	M 4	8.7	4.4
16	14	12	6	5	4.4	8	4.4	M 4	M 5	5.6	5.4
20	19	14	7	7	5.4	9.5	5.4	M 5	M 6	8.6	6.4
25	24	16	10	10	7	11	6.5	M 6	M 8	11.5	8.6
30	29	22	13	13	9	14	8.6	M 8	M10	13.4	11
35	34	24	16	16	11	17.5	10.8	M10	M12	15.2	13

⚠ Escape hole in the screw at the bottom of pin.

■ Standard D_{k6} • component concentricity 0.015 or less

D _{k6}	D	A°	Part No.	
			Type	D
13	+0.012	3	C-TPVX (①+②/Set)	*13
16	+0.001			16
20	+0.015			20
25	+0.002			25
30	+0.015			30
35	+0.018	*5		*35



Order

Part No. — A

C-TPVX16 — 3

•Without *

•With *



Days to Ship

12 Days

Quotation



Price

Order / Quote:

WOS: <https://in.misumi-ec.com/>

TEL:+91-124-468-8800 E-mail:cs@misumi.co.in

⚠ When selecting a pin independently, use a combination of a pin and bushing of the same accuracy.

■ How to Mount

● Standard type

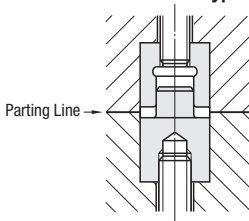

● Pin • Bushing PL installation type

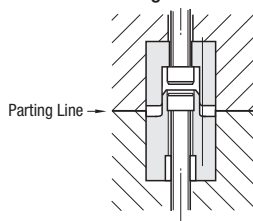

● About dismounting tap hole

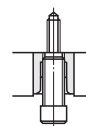

As shown in the figure above, the bushing can be easily removed by screwing a bolt into its tap and extracting it.