

DIN  
TYPE

# DIN TYPE GUIDE BUSHINGS WITH CENTERING HEAD

—PLAIN TYPE—

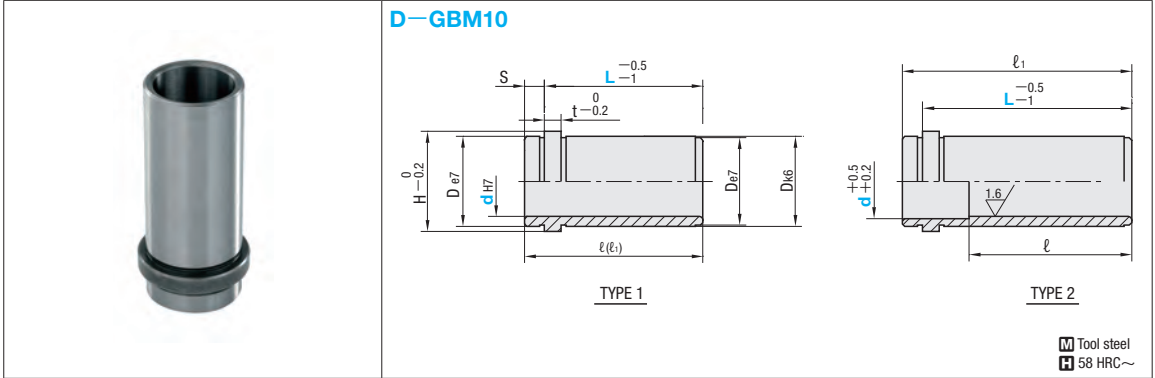

Tool steel  
58 HRC~

TYPE	ℓ	ℓ(ℓ1)	S	t	D	H	Part No. Type	d	L							
										D-GBM10						
1	12	12	3	3	14	16	D-GBM10	9 10	9							
	15	15							12							
	20	20							17							
	25	25							22							
	30	30							27							
	39	39							36							
2	46	49	9	6	26	31		14 15	46							
	49	59							12							
	59	69							17							
1	21	21							9	6	20	25	18 20	12		
	26	26												17		
	31	31												22		
	36	36					27									
	45	45					36									
	55	55					46									
2	56	65					12	10					10	10	22 24	56
	75	75														17
	85	85														22
	95	95	27													
	105	105	36													
	125	125	46													
1	26	26	12	10	12	10			22 24	17						
	31	31								22						
	36	36								27						
	45	45								*36						
	55	55								*46						
	65	65								*56						
2	76	85					12	10	12	10	50 52	*66				
	95	95										*76				
	105	105										86				
	125	125										96				
	145	145										116				
	168	168										136				
1	26	26	12	10	12	10					50 52	17				
	31	31										*22				
	36	36										27				
	45	45										*36				
	55	55										*46				
	65	65										*56				
2	75	75					12	10	12	10	50 52	*66				
	85	85										*76				
	95	95										86				
	105	105										96				
	125	125										116				
	145	145										136				

TYPE	ℓ	ℓ(ℓ1)	S	t	D	H	Part No. Type	d	L				
										D-GBM10			
2	96	125	9	6	30	35	D-GBM10	22 24	*116				
	145	145							136				
	165	165							156				
	31	31							22				
	36	36							*27				
	45	45							*36				
1	55	55						9	6	42	47	30 32	*46
	65	65											*56
	75	75											*66
	85	85											*76
	95	95											*86
	105	105											*96
2	116	145	9	6	42	47	30 32					*136	
	165	165										156	
	185	185										176	
	205	205										196	
	48	48										*36	
	58	58										*46	
1	68	68					12	10	54	60	40 42	*56	
	68	68										*66	
	78	78										*76	
	88	88										*86	
	98	98										*96	
	108	108										116	
2	136	148	12	10	54	60					40 42	136	
	168	168										156	
	188	188										176	
	208	208										196	
	228	228										216	
	248	248										236	
1	68	68					12	10	66	72	50 52	246	
	78	78										56	
	88	88										66	
	98	98										76	
	108	108										86	
	128	128										96	
2	136	145	12	10	66	72					50 52	116	
	168	168										136	
	188	188										156	
	208	208										176	
	228	228										196	
	248	248										216	

dH7		De7		Dk6	
9	+0.015 0	14	-0.032 -0.050	14	+0.012 +0.001
10					
14	+0.018 0	20	-0.040 -0.061	20	+0.015 +0.002
15		26		26	
20		26		26	+0.015 +0.002
22	+0.021 0	30		30	
24		30		30	
30		42	-0.050 -0.075	42	+0.018 +0.002
32		42		42	
40	+0.025 0	54		54	
42		54	-0.060 -0.090	54	+0.021 +0.002
50	+0.030 0	66		66	
52		66		66	



Order

Part No. — d — L  
D-GBM10 — 18 — 17



Days to Ship

with \*  Stock  15 Days  
without \*  Stock  15 Days



Price

Order / Quote:  
WOS: <https://in.misumi-ec.com/>  
TEL:+91-124-468-8800 E-mail:cs@misumi.co.in