

JIS Type  
SKD61 equivalent  
+  
Nitrided

# STRAIGHT EJECTOR SLEEVES

—◎0.08 STANDARD TYPE—

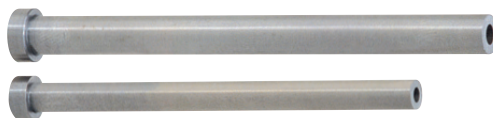

Part No.	D Tolerance	V Tolerance	Applicable center pin shaft diameter tolerance
<b>C-ESN</b>	-0.01 -0.02	H7	-0.01 -0.02 *Please note that the ejector sleeve with a V dimension tolerance of H7 has a long precision fitting portion S and is not suitable for use with a center pin with a shaft diameter tolerance of $-\frac{0}{0.005}$ .

V H7 Tolerance			
$V \leq 3.0$	$3.5 \leq V \leq 6.0$	$6.5 \leq V \leq 10.0$	$V \geq 11.0$
+0.010 0	+0.012 0	+0.015 0	+0.018 0

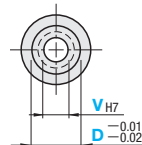
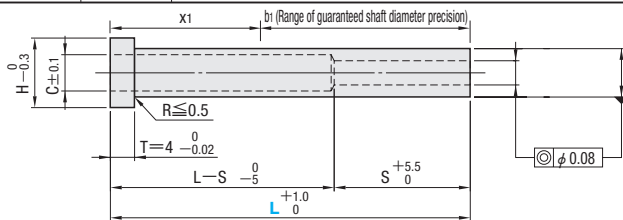

$C = V + 0.5$

Range of guaranteed shaft diameter precision ( $b_1 = L - x_1$ )  
 $x_1$  max.40

M SKD61 equivalent + Nitrided

F Surface: 900HV~

Material: 40±3HRc

L	75	100	125	150	175	200	250	300
S	40	50(V1.5→40)	60(V1.5→40)	60(V1.5→40)	60	80		90

⚠ Nitriding may extend to the head as it is applied after dimension V and D machining.

⚠ The diameter (D) portion of the stepped center pin cannot be inserted into the relief hole (C).

Ejector Sleeves

H	Part No. Type	D	L						V
7	C-ESN	4	75	100	125	150			1.5
			75	100	125	150	175	200	2.0
			75	100	125	150	175	200	2.5
			75	100	125	150			1.5
			75	100	125	150	175	200	2.0
			75	100	125	150	175	200	2.5
8	C-ESN	4.5	75	100	125	150	175	200	2.5
			75	100	125	150	175	200	2.5
			75	100	125	150	175	200	2.5
			75	100	125	150	175	200	2.5
			75	100	125	150	175	200	3.0
			75	100	125	150	175	200	2.0
9	C-ESN	5.5	75	100	125	150	175	200	2.5
			75	100	125	150	175	200	3.0
			75	100	125	150	175	200	3.5
			75	100	125	150	175	200	2.5
			75	100	125	150	175	200	3.0
			75	100	125	150	175	200	3.5
10	C-ESN	6.5	75	100	125	150	175	200	2.5
			75	100	125	150	175	200	2.5
			75	100	125	150	175	200	2.5
			75	100	125	150	175	200	2.5
			75	100	125	150	175	200	2.5
			75	100	125	150	175	200	2.5
11	C-ESN	7.5	75	100	125	150	175	200	2.5
			75	100	125	150	175	200	2.5
			75	100	125	150	175	200	2.5
			75	100	125	150	175	200	2.5
			75	100	125	150	175	200	2.5
			75	100	125	150	175	200	2.5
14	C-ESN	9	75	100	125	150	175	200	2.5
			75	100	125	150	175	200	2.5
			75	100	125	150	175	200	2.5
			75	100	125	150	175	200	2.5
			75	100	125	150	175	200	2.5
			75	100	125	150	175	200	2.5
15	C-ESN	10	75	100	125	150	175	200	2.5
			75	100	125	150	175	200	2.5
			75	100	125	150	175	200	2.5
			75	100	125	150	175	200	2.5
			75	100	125	150	175	200	2.5
			75	100	125	150	175	200	2.5
17	C-ESN	12	75	100	125	150	175	200	2.5
			75	100	125	150	175	200	2.5
			75	100	125	150	175	200	2.5
			75	100	125	150	175	200	2.5
			75	100	125	150	175	200	2.5
			75	100	125	150	175	200	2.5
18	C-ESN	13	75	100	125	150	175	200	2.5
			75	100	125	150	175	200	2.5
			75	100	125	150	175	200	2.5
			75	100	125	150	175	200	2.5
			75	100	125	150	175	200	2.5
			75	100	125	150	175	200	2.5
21	C-ESN	16	75	100	125	150	175	200	2.5
			75	100	125	150	175	200	2.5
			75	100	125	150	175	200	2.5
			75	100	125	150	175	200	2.5
			75	100	125	150	175	200	2.5
			75	100	125	150	175	200	2.5



Part No. — L — V  
C-ESN 8 — 100 — 4.0



Days to Ship **10** Days

⚠ Note that alphabetical CHARACTERS (V) is not necessary in ordering C-ESN.



Order / Quote:  
WOS: <https://in.misumi-ec.com/>  
TEL:+91-124-468-8800 E-mail:cs@misumi.co.in



Part No. — L — V — (KC · WKC...etc.) Alteration details P.68  
C-ESN 8 — 200 — 4.0 — KC4.5