

Locating Pins - Small Flat Head

Press Fit

For products uncovered by e-Catalog Standard, see P.131.

Features: Flat Head Type. Suitable if the mating side has limited space.



(Alteration CN)

RoHS 10

Material No.	Material	Surface Treatment	Hardness	Type		D
				P Selectable	P, L, B Configurable	
(1)	SKS3 Equivalent	-	Treated Hardness: 60~63HRC	JPDB	FPDS	C (m6) PC (p6)
(2)	SKS3 Equivalent	Hard Chrome Plating	Treated Hardness: 50~55HRC Plating Hardness: 750HV ~	-	GFPDS	
(3)	SKS3 Equivalent	-	-	-	BFPDS	
(4)	SUS304*	-	-	SJPDB	SFPDS	
(5)	SUS304	Hard Chrome Plating	Plating Hardness: 750HV ~	-	-	
(6)	SUS440C or 13Cr stainless	-	Treated Hardness: 50~55HRC	-	CFPDS	

* For P Selectable Type, it is SUS304 equivalent.

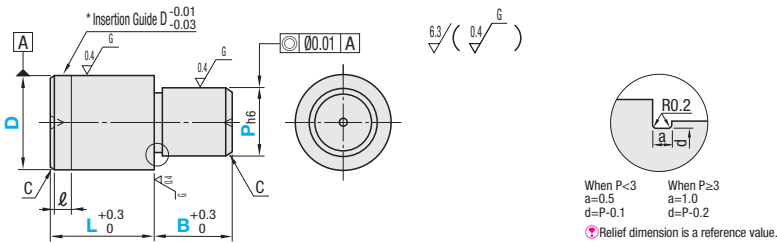

■ P dim. Tolerance Table

P	h6
1.50~3.00	0 -0.006
3.01~6.00	0 -0.008
6.01~10.00	0 -0.009
10.01~18.00	0 -0.011
18.01~20.00	0 -0.013

* The insertion guide is applicable to tolerance p6 only.
 SUS440C or 13Cr stainless has an identification groove at any position on D part.
 Polished, centering hole is sometimes not available for SUS304.
 When D=P, relief is also applied.

■ P Selectable

Type	D Tol.	D	D dim. Tolerance		P Selection	L	B	ℓ	C	Unit Price	
			m6	p6						(1) Treated SKS3 JPDB JPBPC	(4) SUS304 SJPDB SJPBPC
JPDB SJPDB	C (m6) PC (p6)	3	+0.008 +0.002	+0.012 +0.006	2	5	3	1	0.1		
		4			2 3						
		5	+0.012 +0.004	+0.020 +0.012	2 3 4	8			0.5		
		6			3 4 5	10	4				
		8	+0.015 +0.006	+0.024 +0.015	4 5 6	12			1		
		10	+0.018 +0.007	+0.029 +0.018	5 6 7 8	16	5		2		
16			10 13	22	12		3				

■ P, L, B Configurable

Type	D Tol.	D	D dim. Tolerance		P 0.01mm Increment	L 1mm Increment	B 0.1mm Increment	ℓ	C	Unit Price									
			m6	p6						(1) Treated SKS3 FPDSC FPDSC	(2) Hard SKS3 GFPDSC GFPDSC	(3) SKS3 BFPDSC BFPDSC	(4) SUS304 SFPDSC SFPDSC	(6) SUS440C or 13Cr stainless CFPDSC CFPDSC					
FPDS GFPDS BFPDS SFPDS CFPDS	C (m6) PC (p6)	2	+0.008 +0.002	+0.012 +0.006	1.50~2.00	2~5	3.0~10.0	0	0.1										
		3			1.50~3.00	3~10	3.0~10.0												
		4			1.50~4.00	4~10	4.0~10.0												
		5	+0.012 +0.004	+0.020 +0.012	2.00~5.00	5~10	4.0~15.0												
		6			2.00~6.00	5~17	4.0~15.0												
		8	+0.015 +0.006	+0.024 +0.015	3.00~8.00	8~21	6.0~20.0												
		10			3.00~10.00	10~23	6.0~20.0												
		12			5.00~12.00	12~24	6.0~30.0												
		13	+0.018 +0.007	+0.029 +0.018	6.00~13.00	13~26	6.0~30.0												
		16			10.00~16.00	16~32	7.0~30.0												
20			13.00~20.00	20~40	7.0~30.0														

Ordering Example: Part Number - P - L - B
 JPDSC4 - 2
 FPDSC4 - P2.01 - L6 - B5.5

Alterations: Part Number - P - L - B - (RC, CN)
 FPDSC4 - P2.00 - L6 - B5.5 - RC

Alterations	Sphere Tip	C Chamfered Size
	RC (0.5)	C0.5 or Less
Code	RC	CN
Spec.	Changes the relief to R0.5 (Ordering Code) RC Applicable when D-P≥2.	Changes C Chamfering at P dimension part to 0.5 or less. (Ordering Code) CN Not applicable to D dimension part. Applicable when D≥8.

Locating Pins - Small Flat Head

Tapped

For products uncovered by e-Catalog Standard, see P.131.

Features: Small Flat Head with the shape designed to be mounted from back using bolts. Improved maintainability compared to Press Fit Type.



(Alteration CN)

RoHS 10

Material No.	Material	Surface Treatment	Hardness	Type	
				P Selectable	P, L, B Configurable
(1)	SKS3 Equivalent	-	Treated Hardness: 60~63HRC	JPDSTB	FPDSTC
(2)	SKS3 Equivalent	Hard Chrome Plating	Treated Hardness: 50~55HRC Plating Hardness: 750HV ~	-	GFPDSTC
(4)	SUS304*	-	-	SJPDSTB	SFPDSTC
(6)	SUS440C or 13Cr stainless	-	Treated Hardness: 50~55HRC	-	CFPDSTC

* For P Selectable Type, it is SUS304 equivalent.

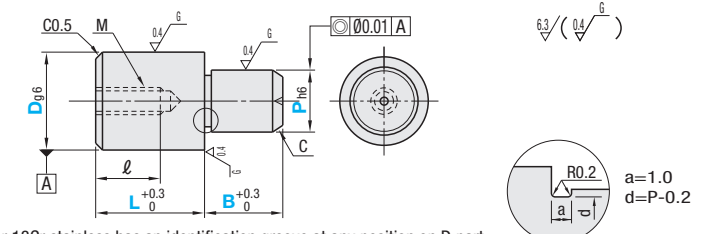

■ P dim. Tolerance Table

P	h6
4.00~6.00	0 -0.008
6.01~10.00	0 -0.009
10.01~18.00	0 -0.011
18.01~20.00	0 -0.013

SUS440C or 13Cr stainless has an identification groove at any position on D part.
 When D=P, relief is also applied.

Relief dimension is a reference value.

■ P Selectable

Type	D	D dim. Tolerance g6	P Selection	L	B	M (Coarse)	Tightening Torque N·cm	ℓ	C	Unit Price	
										(1) Treated SKS3 JPDSTB	(4) SUS304 SJPDSTB
JPDSTB SJPDSTB	6	-0.004 -0.012	4	10	3	M3	98	5	0.5		
	8	-0.005	6	12	4	M4	225	6	1		
	10	-0.014	8	16	5	M5	461	8	1.5		
	12	-0.006	10	20	6	M6	784	9			
	16	-0.017	10 14	24	10	M8	1911	12	3		

■ P, L, B Configurable

Type	D	D dim. Tolerance g6	P 0.01mm Increment	L 1mm Increment	B 0.1mm Increment	M (Coarse)	Tightening Torque N·cm	ℓ	C	Unit Price							
										(1) Treated SKS3 FPDSTC	(2) Hard SKS3 GFPDSTC	(4) SUS304 SFPDSTC	(6) SUS440C or 13Cr stainless CFPDSTC				
FPDSTC GFPDSTC SFPDSTC CFPDSTC	6T	-0.004 -0.012	4.00~6.00	8~17	2.0~15.0	M3	98	5	0.5								
	6T					M2.6	-	4									
	8	-0.005	6.00~8.00	11~21	2.0~30.0	M4	225	6	1								
	10	-0.014	7.00~10.00	11~23	3.0~30.0	M5	461	8									
	10T			8~18		M4	225	6									
	12			7.00~12.00	12~24	3.0~30.0	M5	461	8	1.5							
	12T				8~18		M4	225	6								
	13	-0.006	8.00~13.00	13~26	5.0~30.0	M8	1911	10	2								
	13T	-0.017		10~20		M6	784	9									
	16			10.00~16.00	16~32	5.0~30.0	M8	1911	12								
	16T				10~24		M6	784	9								
	20	-0.007 -0.020	13.00~20.00	20~40	5.0~30.0	M8	1911	12	3								
	20T				12~30		M6	784	9								

Pins of D dimension with T have one size smaller thread diameter and larger wall thickness. (Actual D dimension is the number without "T")

Note the strength of under-head part. P.1618 Please confirm pilot hole depth on P.1618. Holes may go through.

* The tightening torque (ref. value) for hardened products is strength class 8.8. (See technical data on P.2365.) Not applicable when using locking materials or lock washers.

Ordering Example: Part Number - P - L - B
 JPDSTB6 - 4
 FPDSTC6 - P4.00 - L10 - B5.5

Alterations: Part Number - P - L - B - (RC, CN, RAC, LAC)
 FPDSTC6 - P4.00 - L10 - B5.5 - RC

Alterations	Sphere Tip	C Chamfered Size	Hex Socket Machining	Wrench Hole Machining
	RC (0.5)	C0.5 or Less	RAC	LAC
Code	RC	CN	RAC	LAC
Spec.	Changes the relief to R0.5. (Ordering Code) RC Applicable when D-P≥2.	Changes C Chamfering at P dimension part to 0.5 or less. (Ordering Code) CN Not applicable to D dimension part. Applicable when D≥8.	Machines hex sockets. (Ordering Code) RAC Applicable when D≥8. Applicable to P, L, B Dimension Configurable Type only. Combination with LAC is not available.	Machines wrench holes. (Ordering Code) LAC Applicable when D≥8. Applicable to P, L, B Dimension Configurable Type only. Combination with RC or RAC is not available.