

Manual Switching Valves

Lever Type / Miniature Lever Type

Manually Operated Valves / Silencers

Grip Type

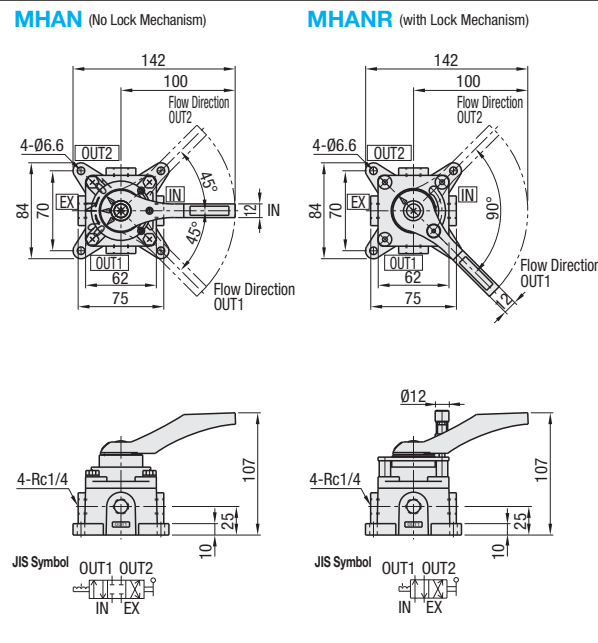

Features

- MHAN : 3-position type of closed center.
- MHANR : 2 Position Type; Lever is locked at the OUT1 and OUT2 positions. Move the lever by pressing the knob for switching.

Components

Component List

Part Number	Name	Quantity	Material
①	Base	1	ADC
②	Cover	1	ADC
③	Common Small Flat Head Screw	1	SS400
④	Lever	1	ADC
⑤	MHAN Bolt	4	SS400
⑥	MHANR Hex Socket Flat Head Cap Screw	4	SCM435
⑦	MHANR Knob	1	SS400
⑧	MHANR Only Stopper Plate	1	SPC
⑧	Collar	4	C3604B

Part Number Type	No.	Direction	Number of Ports	Pipe Connection Bore Dia.		Number of Positions		Effective Sectional Area (mm ²)	Operating Pressure (MPa)	Operating Temp. Range (°C)	Applicable Fluid	Mass (g)		Unit Price	
				IN	OUT	EX	MHAN					MHANR	MHAN	MHANR	
MHAN	4	4	4	Rc1/4	Rc1/4	3	2	20	0~0.7	5~60	Air	800	850		
MHANR															

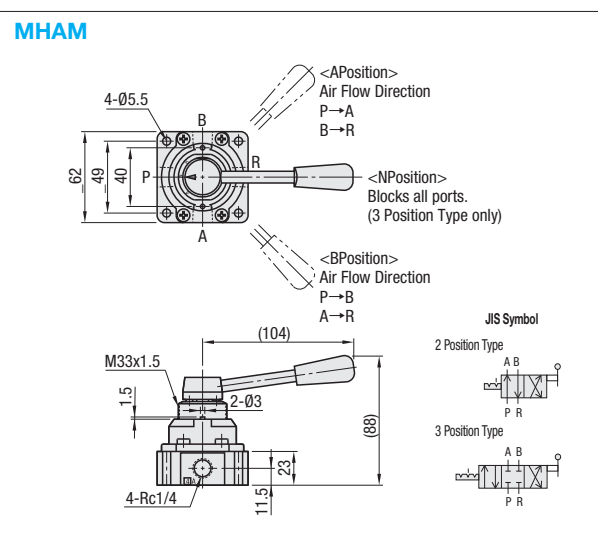

Features

- Lever Type Switching Valves more space-saving than MHAN.
- 3 Position Type has N position, which blocks all ports and can be used for stopping cylinder (Cannot abruptly stop cylinder due to its residual pressure.)

Components

Component List

Part Number	Name	Material
①	Main Body	ADC
②	Cover	ADC
③	Machine Screw	SS400
④	Handle	ZDC
⑤	Lever	SGD400
⑥	Lever Knob	POM

Part Number Type	No.	P Number of Positions	Direction	Number of Ports	Pipe Connection Bore Dia.		Effective Sectional Area (mm ²)	Operating Pressure (MPa)	Operating Temp. Range (°C)	Applicable Fluid	Mass (g)	Unit Price
					IN	OUT						
MHAM	4	2 3	4	4	Rc1/4	Rc1/4	7.5	0~1.0MPa	5~60	Air	280	

Ordering Example: Part Number MHAN4 - 3
 MHAM4 - 3

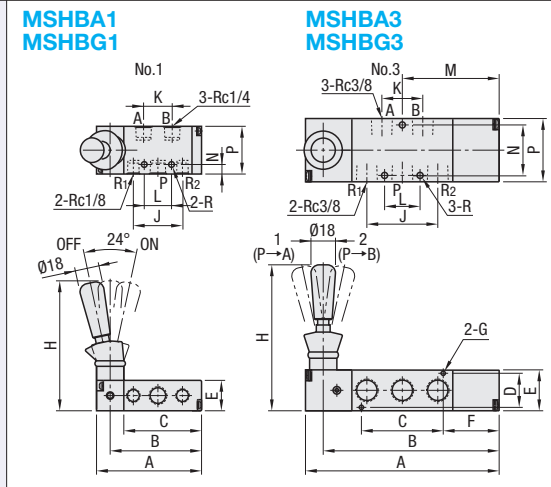

Specifications

Applicable Fluid	Air
Operating Temp. Range	5 ~ 60°C
Operating Pressure Range	0~0.9MPa

Components

Component List

Part Number	Name	Quantity	Material
①	Main Body	1	A6061
②	Pilot Body	1	A6061
③	End Cover	1	(No.1)POM (No.3)A6061
④	Hand Lever	1	POM
⑤	Dust Cover	1	NBR
⑥	Set Screw	2	Carbon Steel
⑦	Screw for Pilot Body	2	Carbon Steel
⑧	End Cover Screw	2	Carbon Steel

Part Number Type	No.	Direction	Number of Ports	Number of Positions	Pipe Connection Bore Dia.		Effective Sectional Area (mm ²)	A	B	C	D	E	F	G	H	J	K	L	M	N	P	R	Mass (g)	Unit Price
					IN	OUT																		
MSHBA	1	4	5	2	Rc1/4	Rc1/8	18	77	67	57	-	22.3	-	95	36	21	20	-	7	35	4.2	200		
MSHBA	3			3	Rc3/8	Rc3/8	34	114	101.5	60	25	30	17	3.2	107	52	30	26	47	37	46.4	4.5	440	
MSHBG	1			3	Rc1/4	Rc1/8	16	97	86.5	71	-	22.3	-	95	36	21	20	-	7	35	4.2	240		
MSHBG	3			3	Rc3/8	Rc3/8	34	142	129	60	25	30	41	3.2	107	52	30	26	71	37	46.4	4.5	490	

Ordering Example: Part Number MSHBA1 MSHBG3

Features: Ensured switching with a lever irrespective of pressure.

MSHBA: Lever position is held at switching point. Air is sure to flow into either A or B port.

MSHBG: Lever returns to the middle position (blocking air) when released. (Cannot abruptly stop cylinder due to its residual pressure.)

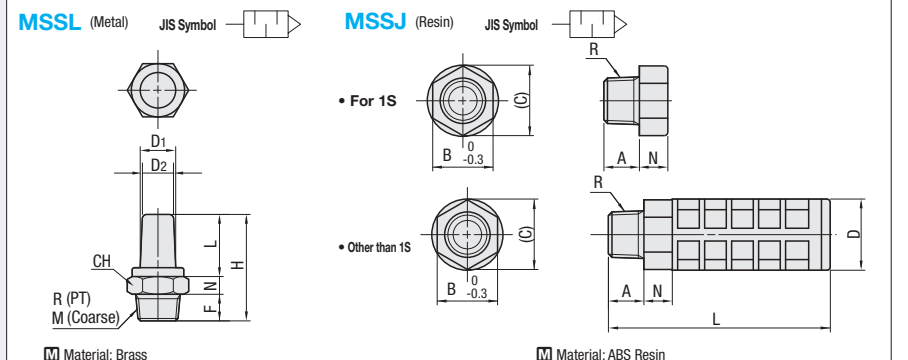
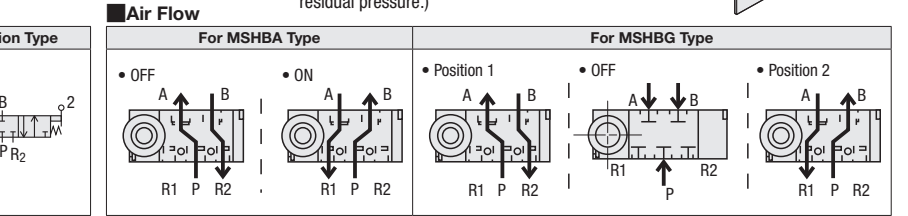
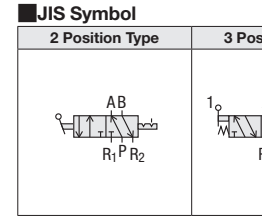

Metal Silencers

Part Number Type	No.	R (PT) M (Coarse)	D1	D2	N	F	L	H	CH (Wrench Flats)	Effective Sectional Area (mm ²)	Unit Price
MSSL	1	R1/8	8	7	4	6	14	24	12	20	
MSSL	2	R1/4	12	10	4	8	18	30	16	45	
MSSL	3	R3/8	14	11	5	9	21	35	18	86	
MSSL	5	M5	5	4	3	5	12	20	8	2	

Resin Silencers

Part Number Type	No.	R	A	B	(C)	D	L	N	Effective Sectional Area (mm ²)	Unit Price
MSSJ	1	R1/8	7	14	16.3	16.1	33	7	12	
MSSJ	1S	R1/8	10	10	11.5	-	-	6	12	
MSSJ	2	R1/4	10	17	19.6	20.1	62.5	8	40	
MSSJ	2S	R1/4	10	14	16.2	16	36	7	20	
MSSJ	3	R3/8	12	24	26	26.3	68	11	63	

Ordering Example: Part Number MSSJ2